

Company/Project Reference: _____ Date: _____

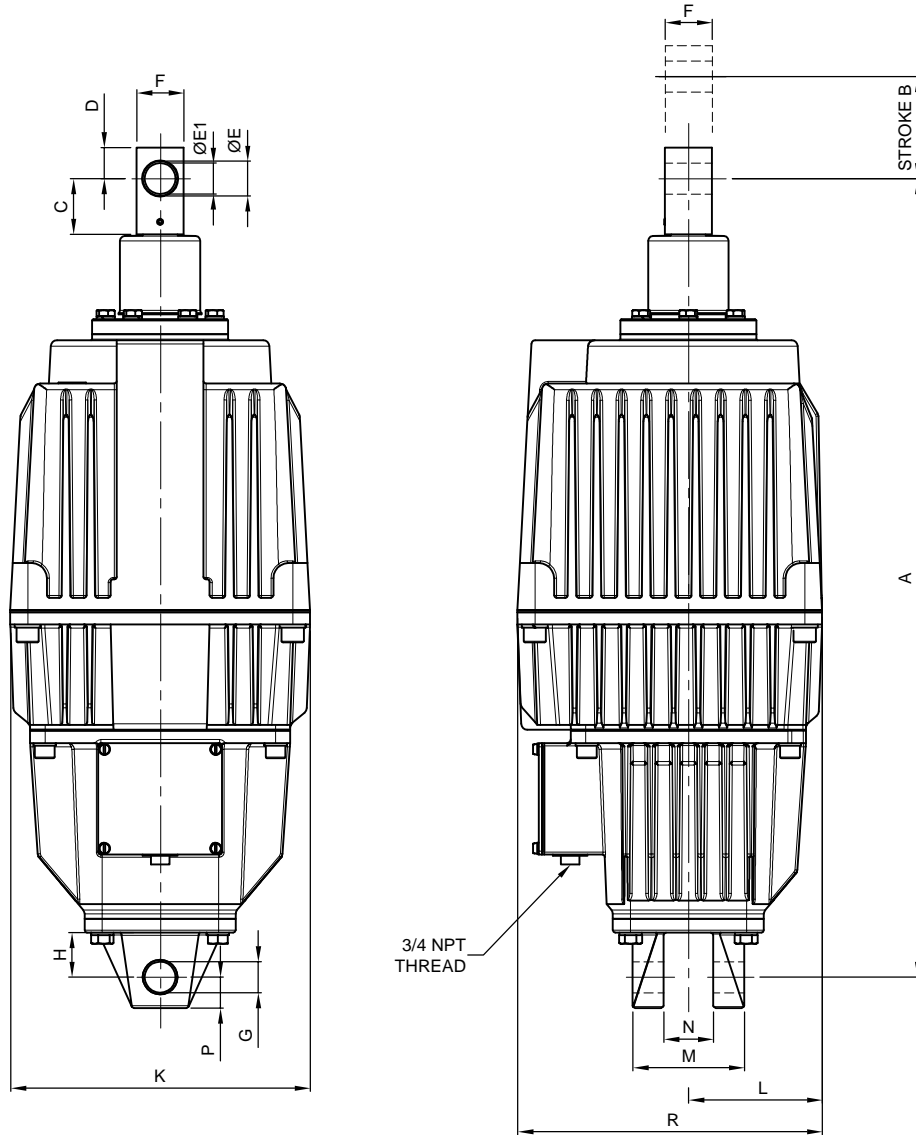

- ALL Specifications and Dimensions in accordance with DIN-15430.

ES-121-060-THRUSTER																			
MODEL No.	NOMINAL FORCE (N)	WEIGHT c/w OIL (kg)	OIL CAPACITY (Litres)	Dimensions (mm)															
				A	B	C	D	E	E ₁	F	G	H	K	L	M	N	P	R	
ES-121-060	1300	43	7.9	645	60	45	25	28	25	38	25	36	242	108	90	40	25	246	

VERTICAL MOUNTING OR HORIZONTAL MOUNTING

Note:

1. - Electrical Motor refer to Thruster Motor Sheet #526-643-36334
2. - Oil Capacity and type refer to Technical Data Sheet # 356-024-35635
3. - Thruster refer to Product Selection Data Sheet #328-331-52744

Rev.	Rev. By	R E V I S I O N S				Date	Rev.	Rev. By	R E V I S I O N S				Date
Reference:		TOLERANCES UNLESS OTHERWISE SPECIFIED: Dimension tolerances on sizes (ISO 2768-m) 0.5 - 3.0 ±0.10 120 - 400 ±0.50 3.0 - 6.0 ±0.10 400 - 1000 ±0.80 6.0 - 30 ±0.20 1000 - 2000 ±1.20 30 - 120 ±0.30 2000 - 4000 ±2.00 BREAK SHARP EDGES 0.2 M/C SURFACES $6.3 \sqrt{\mu m Ra}$				Material:		Weight:	Drawn By:	Scale:			
METRIC						Material No.:		kg		N.T.S.			
						Finish:		Projection					